

#2785

**From:** Brownfield, Jill [jbrownfiel@state.pa.us]  
**Sent:** Thursday, October 08, 2009 3:27 PM  
**To:** dhain@pahouse.net; IRRRC; kebersole@pasen.gov; Kennedy, David C. (AG); Kerry Golden; MULLER, JENNIFER; Smith, Jessie L; Thall, Gregory (GC); wgevans@pasenate.com  
**Subject:** Alternative Flooring Request  
**Attachments:** 20091008144530.pdf

Request for alternative flooring from Melvin Martin.

-----Original Message-----

**From:** aginfo@state.pa.us [mailto:aginfo@state.pa.us]  
**Sent:** Thursday, October 08, 2009 2:46 PM  
**To:** Brownfield, Jill  
**Subject:** [Image File] Jill,, #142

**FROM:**  
Image data has been attached to the e-mail.

RECEIVED  
2009 OCT -9 AM 7:20  
MONTGOMERY COUNTY  
DEPT. OF AGRICULTURE

This is for the  
Canine Health Board

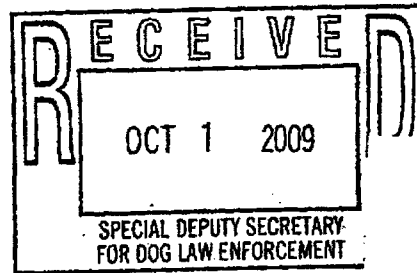

Melvin Martin  
Warrior Run Kennel  
565 Glaze Rd.  
Watertown 17777

#2785

RECEIVED  
OCT 1 2009  
SPECIAL DEPUTY SECRETARY  
FOR DOG LAW ENFORCEMENT

**UNIVERSAL POLY PRODUCTS, LTD.**

**DECKING, PLASTIC & VINYL LUMBER**

33 Hess Road • Leola, PA 17540

P O Box 586 • New Holland, PA 17557

PH: 717-556-3240

Dear Canine Health Board

This is a request to consider an alternative flooring for the porch of my kennel.

I have solid flooring in my primary enclosures and stone and grass exercise areas with free access. Directly outside the primary enclosure and between primary enclosure and exercise area I have a porch with plastic slotted flooring. The reason for this is to allow dirt and small stones to fall off of the dogs feet before entering primary enclosure.

I can assure you that this is very helpful in keeping a considerable amount of dirt outside, as my old kennel had solid porch floors. over

Further, I have this plastic porch floor hinged to lift up for clean out.

This flooring was purchased from Raber kennel and Supplies in Ohio. If you are familiar with this flooring and can approve this use please reply in writing.

If you will need to see a sample I will ship or deliver a peice to you. Thank You  
Melvin

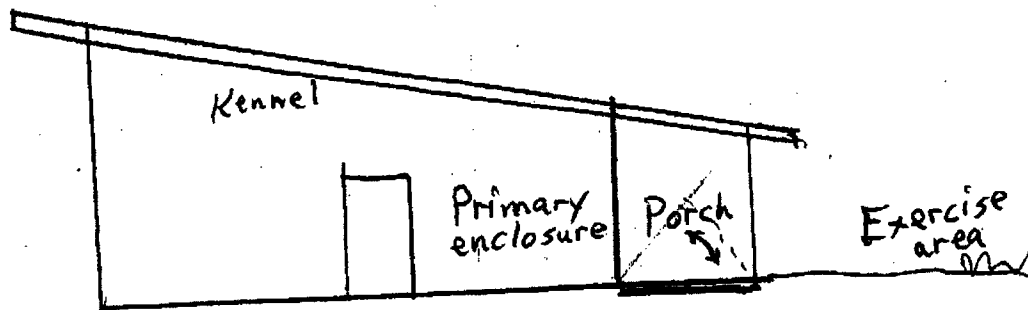

### HEAVY DUTY KENNEL FLOOR...

- 2' x 8' size
- 2 1/2" high.
- 1 1/2" x 2 1/2" holes.
- Easy setup for double deck.
- Use 2" abs plastic pipe for legs.
- You furnish pipe to your length.
- Ideal for medium to large dogs.

...\$69.00



catalog picture of  
requested flooring.

#2785

**From:** Brownfield, Jill [jbrownfiel@state.pa.us]  
**Sent:** Thursday, October 08, 2009 4:46 PM  
**To:** dhain@pahouse.net; IRRRC; kebersole@pasen.gov; Kennedy, David C. (AG); Kerry Golden; MULLER, JENNIFER; Smith, Jessie L; Thall, Gregory (GC); wgevans@pasenate.com  
**Subject:** Scanned comment from Melvin Martin  
**Attachments:** 20091008144530.pdf

-----Original Message-----

**From:** aginfo@state.pa.us [mailto:aginfo@state.pa.us]  
**Sent:** Thursday, October 08, 2009 2:46 PM  
**To:** Brownfield, Jill  
**Subject:** [Image File] Jill,, #142

**FROM:**  
Image data has been attached to the e-mail.

RECEIVED  
OCT 14 2009

OCT 14 2009

RECEIVED

This is for the  
Canine Health Board

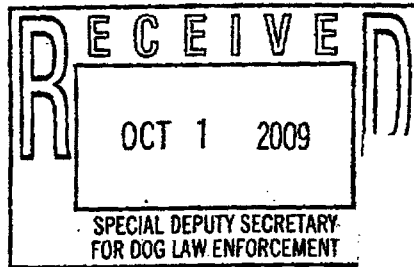

Melvin Martin  
Warrior Run Kennel  
565 Glaze Rd.  
Watson town 17777

# 2785

RECEIVED  
OCT 1 2009

**UNIVERSAL POLY PRODUCTS, LTD.**

**DECKING, PLASTIC & VINYL LUMBER**

33 Hess Road • Leola, PA 17540

P O Box 586 • New Holland, PA 17557

PH: 717-556-3240

Dear Canine Health Board

This is a request to consider an alternative flooring for the porch of my kennel.

I have solid flooring in my primary enclosures and stone and grass exercise areas with free access. Directly outside the primary enclosure and between primary enclosure and exercise area I have a porch with plastic slotted flooring. The reason for this is to allow dirt and small stones to fall off of the dogs feet before entering primary enclosure.

I can assure you that this is very helpful in keeping a considerable amount of dirt outside, as my old kennel had solid porch floors. over



Further, I have this plastic porch floor hinged to lift up for clean out.

This flooring was purchased from Raber kennel and Supplies in Ohio. If you are familiar with this flooring and can approve this use, please reply in writing.

If you will need to see a sample I will ship or deliver a peice to you. Thank You  
melvin

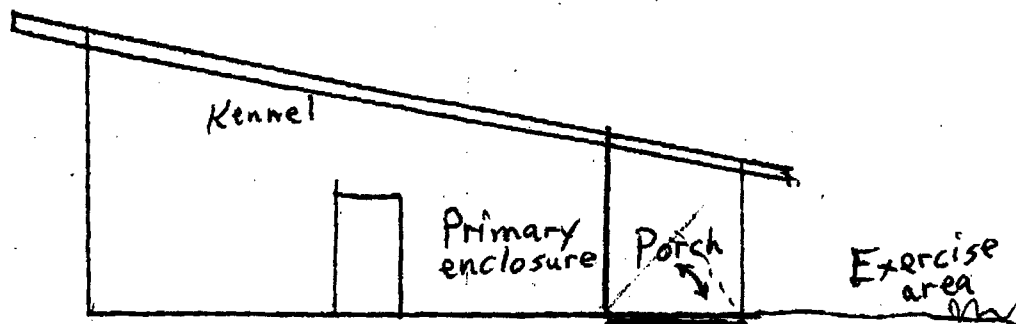

### HEAVY DUTY KENNEL FLOOR...

- 2 $\frac{1}{2}$ " high. 3' x 8' size
- 7" x 2 $\frac{1}{2}$ " holes.
- Easy setup for double deck.
- Use 2" abs plastic pipe for legs.
- You furnish pipe to your length.
- Ideal for medium to large dogs.

...\$69.00



catalog picture of  
requested flooring.